



32442 Asst.

OVER 18M-4Y

123

SESAME STREET

Squeeze-a-Song™



**TO PLAY:**

Squeeze Cookie Monster's tummy to hear him sing, "Twinkle, Twinkle, Little Star" or "Mary Had a Little lamb". The harder you squeeze, the louder he sings!

Cookie Monster will sing one note per squeeze. Keep squeezing to hear the whole song!

**TO PLAY:**

Squeeze Elmo's tummy to hear him sing "Twinkle, Twinkle, Little Star" or "Mary Had a Little lamb". The harder you squeeze, the louder he sings!

Elmo will sing one note per squeeze. Keep squeezing to hear the whole song!

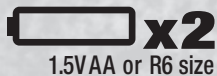

**BATTERIES INCLUDED**

Replace with 2 x 1.5V "AA" or R6 size batteries. Alkaline batteries recommended. Phillips/cross head screwdriver (not included) needed to replace batteries.



## Troubleshooting:

If you get no response, replace batteries.

### TO REPLACE BATTERIES:

Use a Phillips/cross head screwdriver (not included) to loosen screw in battery compartment cover (screw remains attached to cover). Remove cover. Remove and discard old batteries. Replace with fresh 2 x 1.5V "AA" or R6 size batteries. Alkaline batteries recommended. Replace cover and tighten screw.

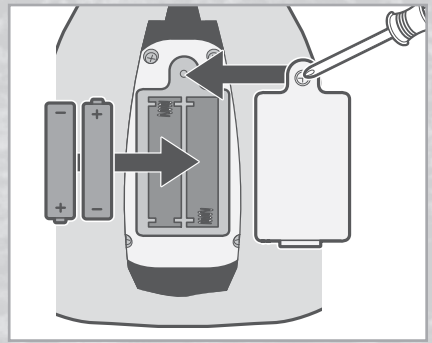

## IMPORTANT: BATTERY INFORMATION



### CAUTION:

1. Always follow the instructions carefully. Use only batteries specified and be sure to insert them correctly by matching the + and - polarity markings.
2. Do not mix old batteries and new batteries or standard (carbon-zinc) with alkaline batteries.
3. Remove exhausted or dead batteries from the product.
4. Remove batteries if product is not to be played with for a long time.
5. Do not short-circuit the supply terminals.
6. Should this product cause, or be affected by, local electrical interference, move it away from other electrical equipment. Reset (switching off and back on again or removing and re-inserting batteries) if necessary.
7. RECHARGEABLE BATTERIES: Do not mix these with any other types of batteries. Always remove from the product before recharging. Recharge batteries under adult supervision. DO NOT RECHARGE OTHER TYPES OF BATTERIES.

### FCC STATEMENT

This device complies with Part 15 of the FCC Rules. Operation is subject to the following two conditions: (1) This device may not cause harmful interference, and (2) this device must accept any interference received, including interference that may cause undesired operation.

NOTE: This equipment has been tested and found to comply with the limits for a Class B digital device, pursuant to Part 15 of the FCC Rules. These limits are designed to provide reasonable protection against harmful interference in a residential installation. This equipment generates, uses and can radiate radio frequency energy, and, if not installed and used in accordance with the instructions, may cause harmful interference to radio communications. However, there is no guarantee that interference will not occur in a particular installation. If this equipment does cause harmful interference to radio or television reception, which can be determined by turning the equipment off and on, the user is encouraged to try to correct the interference by one or more of the following measures:

- Reorient or relocate the receiving antenna.
- Increase the separation between the equipment and receiver.
- Consult the dealer or an experienced radio/TV technician for help.

CAUTION: Changes or modifications to this unit not expressly approved by the party responsible for compliance could void the user's authority to operate the equipment.

Learn and play at  
[SesameStreet.org](http://SesameStreet.org)

32442 Asst. PN 7179420001

Product and colors may vary.

Questions? Call 1-800-327-8264



® and/or TM & © 2011 Hasbro. All Rights Reserved. TM & © denote U.S. Trademarks. U.S. Pat. No. 6733359

Sesame Workshop®, Sesame Street® and associated characters, trademarks and design elements are owned and licensed by Sesame Workshop. © 2011 Sesame Workshop. All Rights Reserved.